



Máquina: Máquina Afiar Universal

Marca: Arti Bileme

Modelo: UTB-POWER



Quick setup



Specially designed for tools with PowerLock system.



Precise grinding with hydraulic right-left table movement.



Grinding wheel cutting rev.	3000 r.p.m.
Rotation diameter in axis	200mm
Wheel motor height movement	Vertical 250mm
Wheel motor lock (infeed) angle	±45°
Grind tool diameter	Ø50-350mm
Table dimensions	980*230mm
Table movement X/Y	550/200mm
Divisor rotation angle	360°
Divisor output number	2-3-4-6-8-12-24-36
Grinding wheel outside diameter	Ø150mm
Grinding wheel bore diameter	Ø20mm
Coolant motor capacity	35 l/min.
Coolant container capacity	~500l.
Motor quantity	3
Total power	1,40kW
Voltage	380V, 3Ph, 60Hz
Net gross weight	700/725kg
Dimensions	160*160*200cm.

Grinding wheel:

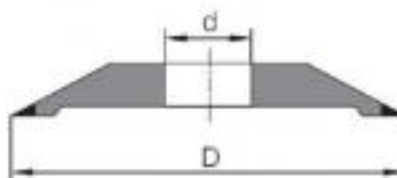
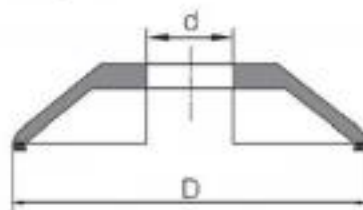

Rough Wheel

Type : 12V9
D : Ø150 mm
d : Ø20 mm
Oil Coolant

Finish Wheel

Type : 4A2
D : Ø150 mm
d : Ø20 mm
Oil Coolant

Referência

-

Preço

Sob Consulta

Marca

Arti Bileme

Modelo

UTB-POWER

Nº de série

-

Ano

-

Descrição

Máquina afiar universal hidráulica automática para ferramentas de corte (lâminas finger joint, brocas, fresas, cabeçotes) (com Power Lock) ARTI BILEME - UTB-POWER

Hydraulic automatic universal tool sharpening machine (paneling cutters, straight milling cutters, router bits and finger-joint knives) (with Power Lock) ARTI BILEME - UTB-POWER

Affûteuse universel hydraulique automatique pour outils de coupe (lames finger joint, perceuses, fraises, mèches de toupie) (avec Power Lock) ARTI BILEME - UTB-POWER



J. FERREIRA & JESUS
INDUSTRIAL EQUIPAMENTOS

MÁQUINAS E FERRAMENTAS
para trabalhar madeira
EQUIPAMENTOS INDUSTRIAIS



Dimensões Mesa : 980*230mm

Movimento X/Y : 550/200mm...